



PHOTON 4 HEALTH
NEXT LEVEL LIGHT THERAPY

ENGLISH USER MANUAL



BRAINHEALER[®]
BASIC

► INTRODUCTION

Congratulations on your BRAINHEALER® BASIC biophoton therapy device. This innovative device was developed based on over 12 years of experience in biophoton therapy with over 10,000 users. We are excited that you are part of the health revolution made possible by this new generation of lightweight biophoton therapy devices—the BRAINHEALER® BASIC and BRAINHEALER® GUTBRAIN. The light wavelengths (light colors) used by PHOTON 4 HEALTH® have been proven effective in hundreds of scientific studies. Each BRAINHEALER® BASIC also features a patented frequency modulation program designed to support brainwave function and the body's natural healing process. Please read this manual carefully before use to ensure optimal and safe use of the device for optimal results.

NOTICE

For best results, power your BRAINHEALER BASIC (and possibly your BRAINHEALER GUTBRAIN) only with the BRAINHEALER power bank.



▶ PRODUCT DIAGRAM

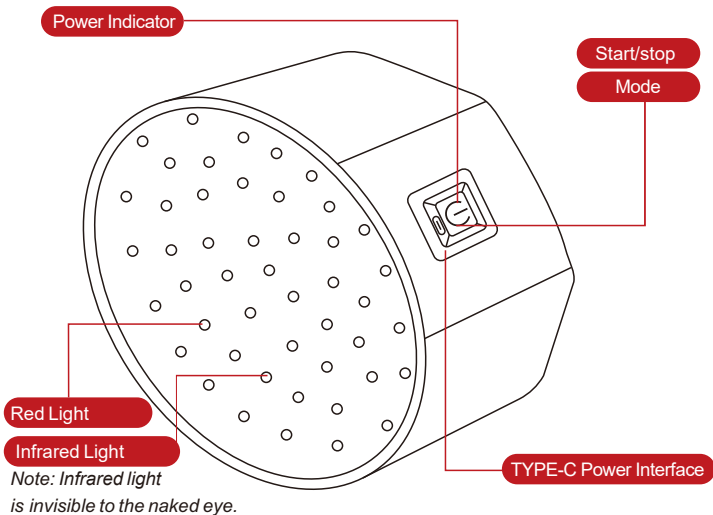

WHAT'S INCLUDED

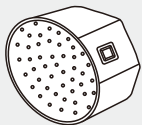

- Cap x 1



- Powerbank + charger



- User manual x 1



- TYPE-C cable x 1



- Aluminum suitcase

▶ TREATMENT MODES

STANDBY MODE

If the Mode light is green you know that the BRAINHEALER is receiving power but no program is active.



BRAINHEALER

Press once and the Mode light turns blue. When the light is blue, the 30-minute patented BRAINHEALER program is active.



SLEEP PROGRAM

Press again and the Mode light will turn red. This indicates that the 10-minute sleep program is activated. Only sleep-enhancing brainwaves are emitted. Use this program shortly before bed to improve your sleep quality.



The patented BRAINHEALER® program consists of frequencies that balance Delta, Theta, Alpha, Beta, and Gamma brainwaves. These frequencies are mixed with bioresonance frequencies that positively influence your overall well-being and self-healing capacity. All of this is delivered through red/infrared LEDs and infrared patented biophoton lasers, which increase the body's biophoton reserves and thus improve your cell communication. Unfortunately, we cannot make any medical claims about the health benefits of this. However, if you use the BRAINHEALER daily, we are convinced that you will soon experience the miraculous effects yourself and be able to share them with your loved ones.

► HOW TO USE

1

Insert USB cable to the powerbank and connect to the power switch on the cap.

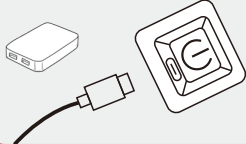

2

When the light is green, it means the BRAINHEALER® BASIC is receiving power. If the light is not green, first press the button on the power bank to turn it on. Then, press the green button on the Brainhealer to start the BRAINHEALER program (30 minutes). The light will then turn blue. Would you prefer the sleep optimization program? (10 minutes) Click again to switch to the sleep optimization program; the light will turn red.

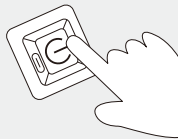

3

Put the BRAINHEALER® BASIC on your head.

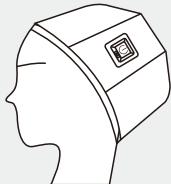

4

If you also have a BrainHealer GUTBRAIN, you can use it simultaneously (only one power bank needed).



5

When a program is complete, the light will turn green again. If you do nothing, the power bank will turn off after 1 minute.

▶ THE FEATURES AND BENEFITS

Brain health is a long-term process that requires your attention and investment. It takes time and daily use. Hundreds of clinical studies have proven that biophoton therapy positively impacts brain health, overall health, and self-healing capacity. We believe your body benefits from every use. However, many factors can influence the speed at which your symptoms improve. Generally, it can take up to four weeks for health issues to improve, provided you use the product daily. By using the product consistently every day, you can maximize the activity of your self-healing capacity.



If you have questions about specific conditions, we recommend consulting a trusted healthcare provider or physician or contacting us directly for a free consultation.

Product Specifications

Product brands: PHOTON 4 HEALTH® BRAINHEALER® model name: BASIC

Led Qty : 108pcs (dual chips, 54pcs 630nm chips+54pcs 1070nm chips)

Laser Qty: 66 pcs (48pcs 785nm, 6pcs 850nm, 6pcs 1070nm, 6pcs 665nm)

Timer : 30 minutes or 10 minutes

Material : Lycra

Diameter : 20 cm

Weight : 150 g

Power : Type-c 5V-2A

Powerbank Capacity : 20.000mAh,
(6 hours of treatment on one charge)

► WARNING

- * This product should never get wet.
- * Cleaning may only be done with a dry cloth.
- * Do not use the device when cords or plugs are damaged.
- * Do not use the device if it is damaged or comes in contact with water.
- * Do not carry or lift up the device by the power cord.
- * Do not use the device near hot surfaces or environment.
- * Do not fold or place heavy objects on the device.
- * Store the device with the aluminum suitcase to avoid any kind of damage.

1 Keep the product and its components out of reach of children.

2 do not use this device if you have had an organ transplant.

► WARRANTY

This product comes with a free 3-year warranty and lifetime maintenance service. If you experience any issues with your product (not caused by human intervention) within 3 years of purchase, please contact us. We'll be happy to help. Please note: This warranty does not cover damage to this product resulting from accident, abuse, misuse, or failure to follow the instructions.

For more information about our products, please visit www.photon4health.com or email info@photon4health.com

This device is manufactured in Europe by

PHOTON 4 HEALTH B.V.

Zwartewaterallee 56

8031 DX Zwolle

the Netherlands

